

MIDDLEMOD™

Prefabricated Kitchen/Bath Modules

Service Cores

Flexible Design • Crane Set Directly Into Place
Full System Integration • Just In Time Delivery



- Full Service Design, Manufacture, Delivery and Install
- Contains each living unit's mechanical and electrical systems for plug and play install
- Washington L&I gold tagged for fewer inspections on site
- Customized to your structural and design needs
- Factory assembly lowers your field costs
- Protective packaging keeps your schedule flexible
- Lower your overhead, shorten your schedule, and build smarter

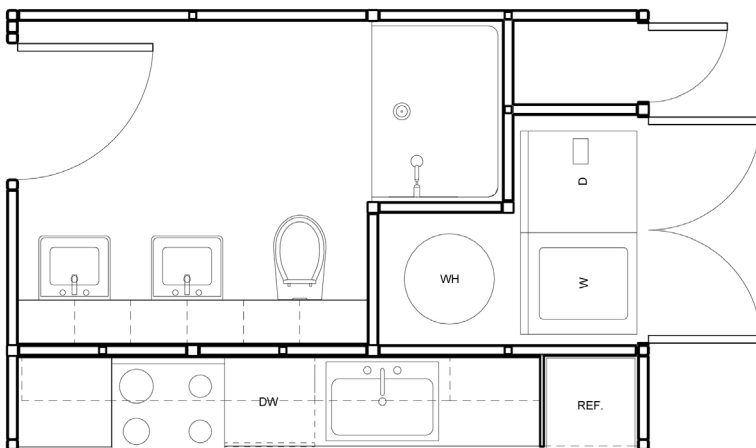
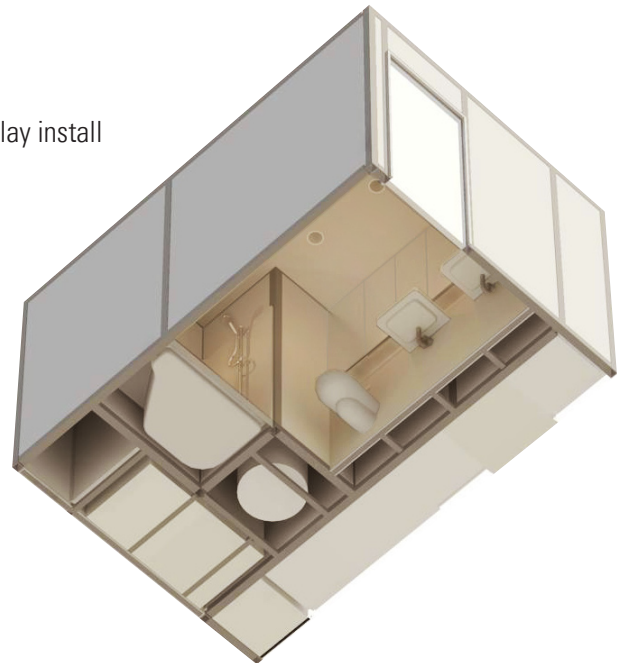

BaMM
Building and Module Manufacturing

425-482-4422 P.O. Box 1491, Woodinville, WA 98072

a collaboration of:

